

Stuttgart, Germany

# PANO BROT & KAFFEE



Architect:  
DIA – Dittel Architekten

Year of completion:  
2014

Gross floor area / seats:  
225 m<sup>2</sup> / approx. 100

Specialty:  
House-made coffee blends



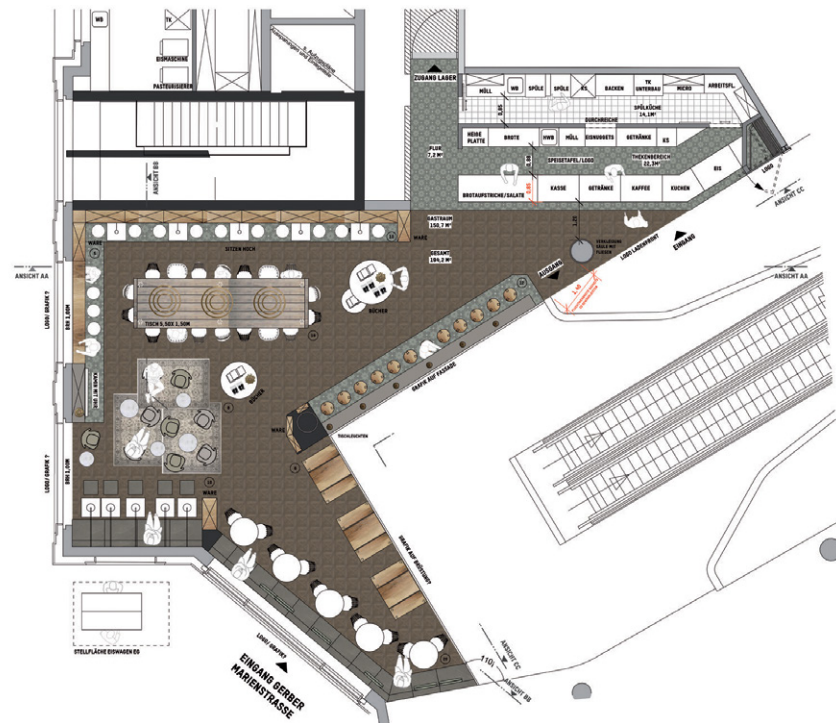

Solid wood and high quality decorative elements express the company's core values.

In the heart of Stuttgart DIA – Dittel Architekten have designed the city's first Pano Brot & Kaffee subsidiary. The café invites customers to enjoy handmade organic and locally sourced products in a comfortable and friendly atmosphere. Visitors to the café experience a harmonious, warm environment. The 225-square-meter room sports an unusual ceiling element that unfolds from the entrance towards the rear of the café. The use of high-quality materials, such as oak wood, hand-sewn real leather and Italian tiles, reflect the company's values: tradition, honesty and quality, making the Pano brand tangible.

A comfortable atmosphere makes the customers feel at home.



The product range consists of regional, organic and handmade products, thus expressing a sustainable and responsible approach.

